



VASCULAR ACCESS

single-lumen central venous catheter

leader**cath** 2 E.L.

leader**cath** 2 E.L. +



Value Life

25.

## leadercath 2 E.L. Single-lumen central venous catheter in Polyurethane

## leadercath 2 E.L. + Single-lumen central venous catheter in Polyurethane

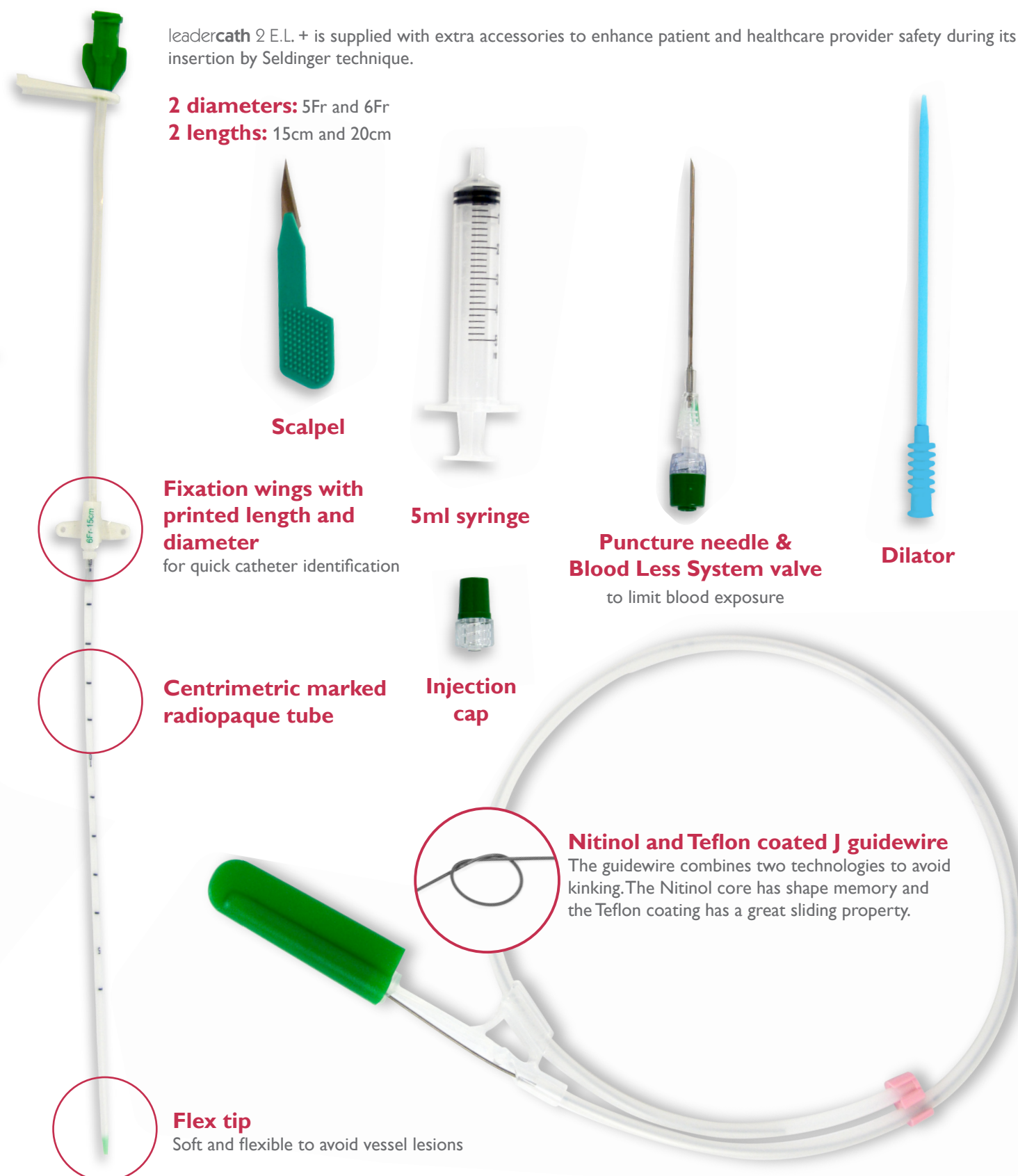
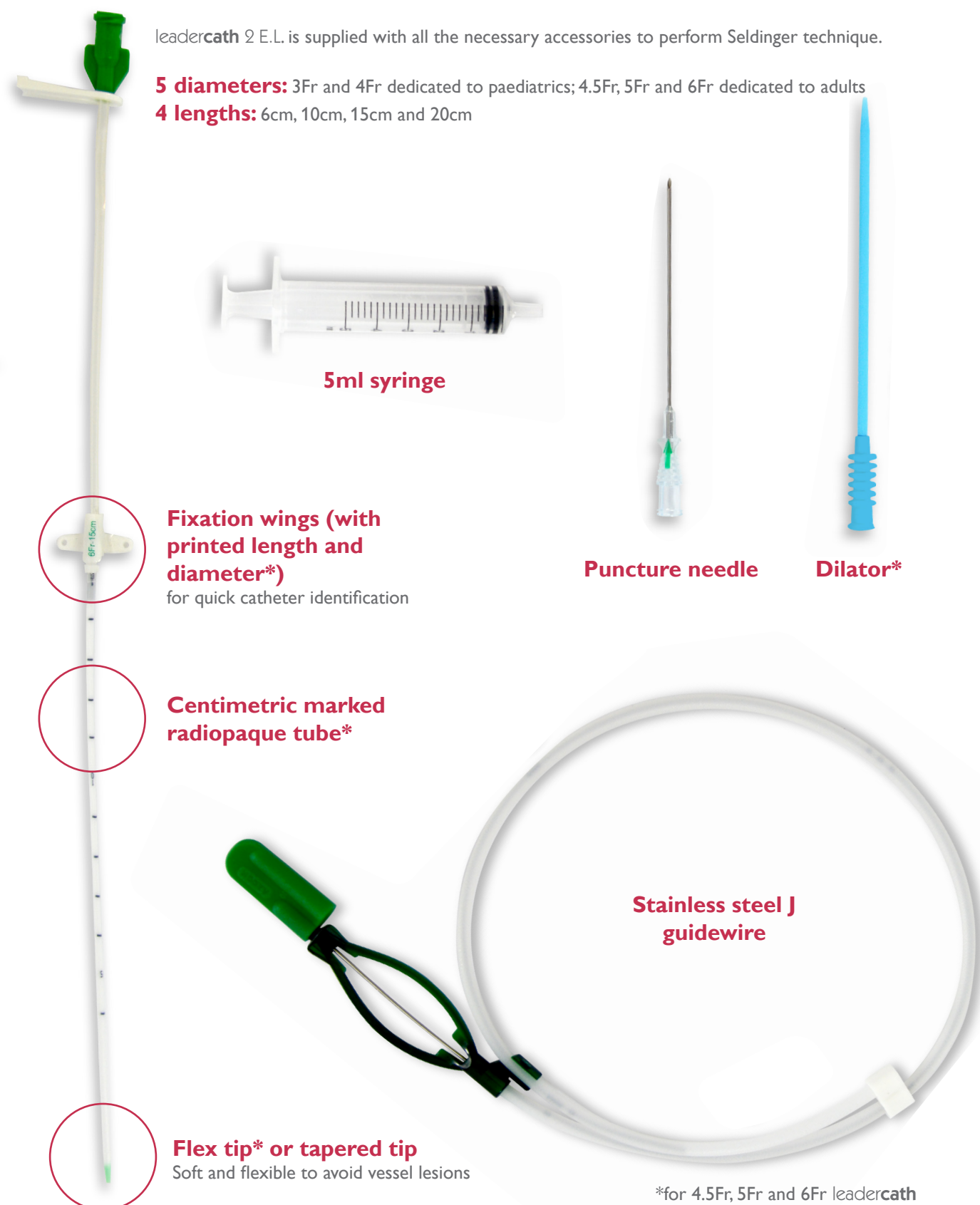

leadercath 2 E.L.	25. leadercath 2 E.L. +	Catheter information			Guidewire		Needle		Unit of sales /box
		Length cm	Ø Fr (mm)	Flow rate (ml/min)	Length cm	Ø mm	Length m	Ø G	
1241.06	-	6	3 (0.9)	16	30	0.5	38	20	5
1243.10	-	10	4 (1.2)	26	40	0.7	54	19	5
1245.15	-	15	4.5 (1.5)	45	53	0.7	70	19	5
1245.17	1245.171	15	5 (1.7)	65	53	0.97	70	17	5
1245.20	1245.201	15	6 (2)	110	53	1.1	70	16	5
1248.15	-	20	4.5 (1.5)	30	53	0.7	70	19	5
1248.17	1248.171	20	5 (1.7)	57	53	0.97	70	17	5
1248.20	1248.201	20	6 (2)	80	53	1.1	70	16	5

## CRITICAL CARE

**For further information, please contact: [questions@vygon.com](mailto:questions@vygon.com)**

The specifications shown in this leaflet are for information only  
and are not, under any circumstances, of a contractual nature.

Vygon – 5, rue Adeline • 95440 ECOUEN • FRANCE

Reception: +33 (0)1.39.92.63.63 – Service clients France: +33 (0)1.39.92.63.81

Export customer service: +33 (0)1.39.92.64.15

Fax.: +33 (0)1.39.92.64.44 • [www.vygon.com](http://www.vygon.com)



[www.vygon.com](http://www.vygon.com)